

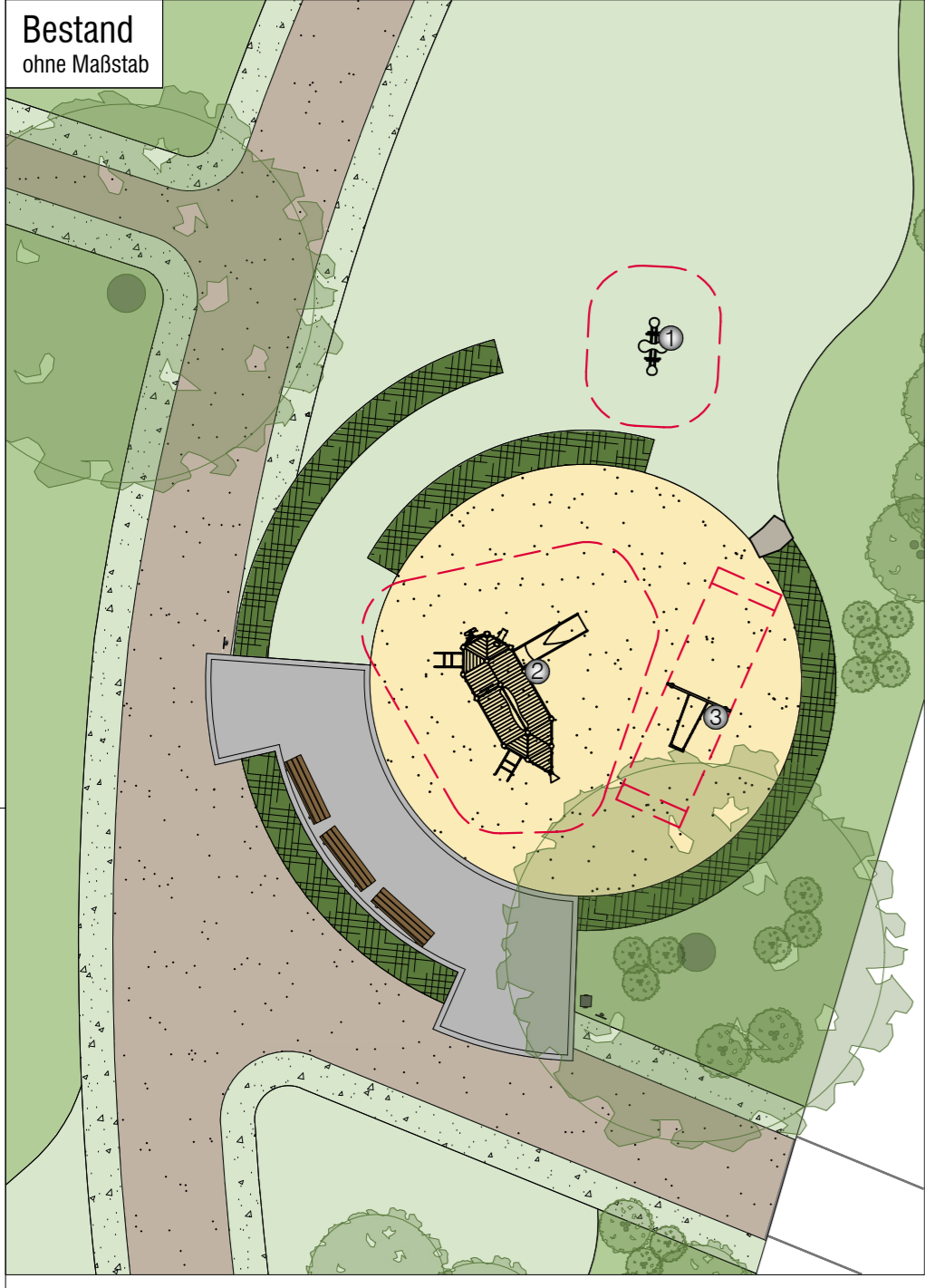

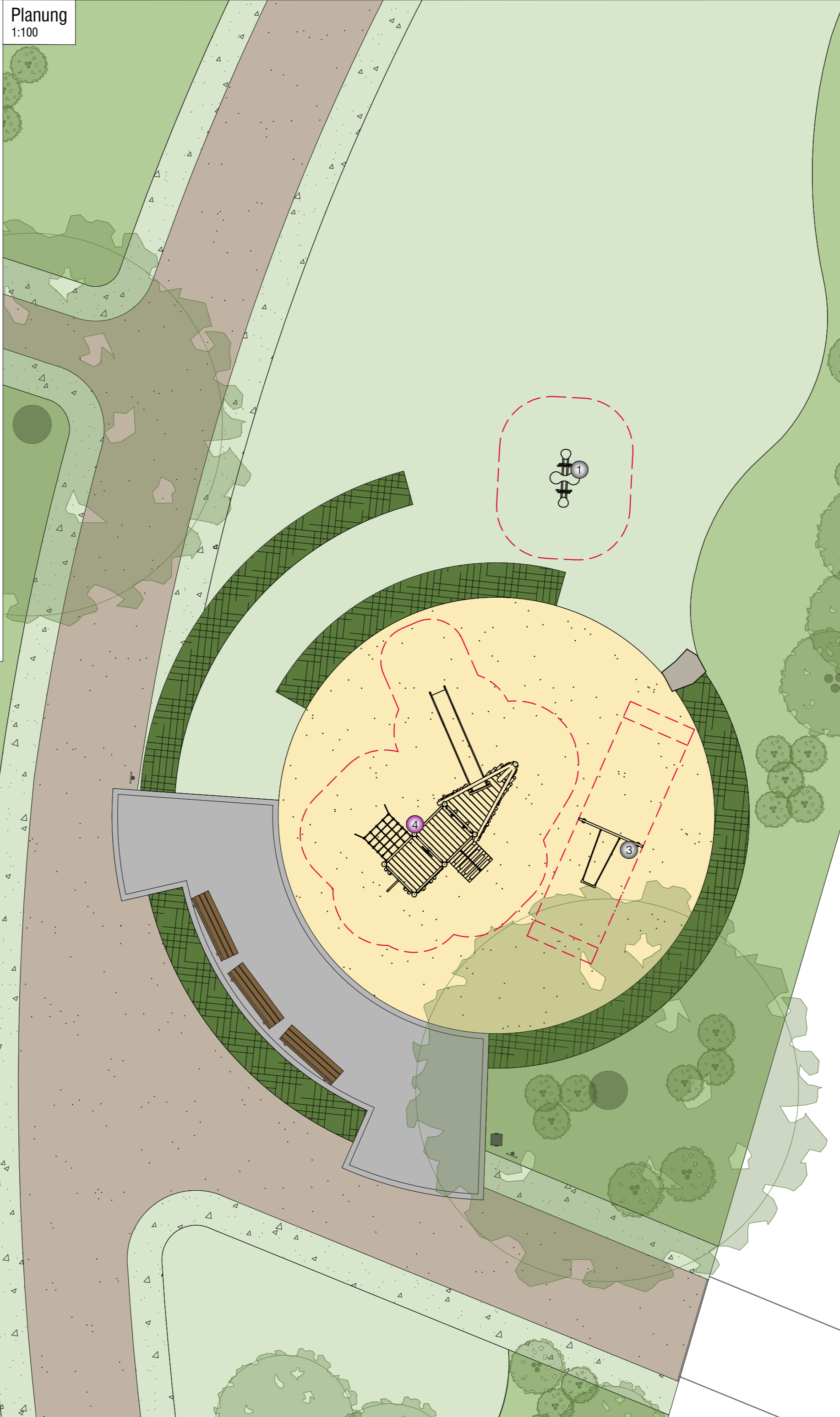







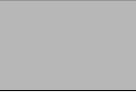

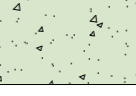
Bestand
ohne Maßstab



Planung
1:100



Legende



-  Pflaster
-  wassergebundene Decke
-  Sand
-  Schotterrasen
-  Rasen
-  Pflanzung
-  Hecke
-  Baum
-  Strauch
-  Sandsteinblock
-  Bank
-  Spielplatzschild
-  Abfalleimer

Bestand

- ① Doppelfederwippe
Fa. Kaiser & Kühne
- ② Spielkombination "Sandfrachter", abgängig
Fa. Kaiser & Kühne
- ③ Schaukel
Fa. Kaiser & Kühne

Planung 2025

- ④ Varioset "Föhr"
Art.-Nr.: V01140050S
Fa. FHS

Projekt-Nr.: 3806		Objekt-Nr.: 27711																						
Plan Nr.: K 310/1		Datum: 29.10.2025																						
Amtsleitung: gez. P. Driesch		Bearbeitet: gez. S. Reinmuth		Amt für Grünflächen, Umwelt und Nachhaltigkeit																				
Abteilungsleitung: gez. B. Schumann		Gezeichnet: gez. M. Tewes																						
Fachstellenleitung: gez. J. Hoffmann		 Maßstab: 1:100		<h2 style="margin: 0;">Spielplatz Drei Eichen Mitte</h2> <p style="margin: 0;">Sanierung 2025</p>																				
<table border="1" style="width: 100%; border-collapse: collapse;"> <thead> <tr> <th style="width: 10%;">Geändert:</th> <th style="width: 60%;">Index</th> <th style="width: 20%;">Inhalt</th> <th style="width: 10%;">Datum</th> <th style="width: 10%;">Bearbeiter</th> </tr> </thead> <tbody> <tr> <td>...</td> <td>...</td> <td>...</td> <td>...</td> <td>...</td> </tr> <tr> <td> </td> <td> </td> <td> </td> <td> </td> <td> </td> </tr> <tr> <td> </td> <td> </td> <td> </td> <td> </td> <td> </td> </tr> </tbody> </table>					Geändert:	Index	Inhalt	Datum	Bearbeiter										
Geändert:	Index	Inhalt	Datum	Bearbeiter																				
...																				